

Coil and spool dispensing unit, manual



Fig. 1 KOMBITRAK 800 T with coiler head RAPID 800 SL



Fig. 2: KOMBITRAK 800 B with coiler head RAPID 800 SL

Basic equipment

- Steel profile frame with four brakable steering rollers
- **(KOMBITRAK 800 T - Part-no: 85100912)** Drive unit consisting of brake disc with pendulum for opening and closing the rope brake, tensile force of the pendulum lever adjustable at the tension spring
- **(KOMBITRAK 800 B - Part No. 87000305)** Drive unit consists of adjustable mechanical brake
- Spool receipt for kabelmat® winding axles or winding heads in vertical construction
- Spool loading via lifting truck, forklift truck or manually

Technical details

Spool- / Coil diameter	max. 800 mm
Spool- / Coil width	as per specification of winding axle/ coiler head
Spool- / Coil weight	as per specification of winding axle/ coiler head
Locating bore	30 mm
Loading weight	max. 100 kg
Direction of material flow	from the right to the left
L x W x H	approx. 1200 x 1000 x 1000 mm
Colour	RAL 7005 mouse grey
Weight	abt. 70 kg

Coil and spool dispensing unit, manual

Basic frame



Fig. KOMBITRAK 800 B

Basic frame	KOMBITRAK 800 B Art.-Nr. 87000305	KOMBITRAK 800 T Art.-Nr. 85100912
	with mechanical brake	with pendulum and mechanical brake
Coiler head-Ø	max. 800 mm	max. 800 mm
Spool-Ø	max. 800 mm	max. 800 mm
Loading bore	30 mm	30 mm
Loading weight	max. 100 kg	max. 100 kg
L x W x H	approx. 1200x1000x1000 mm	approx. 1200x1000x1000 mm
Weight	approx. 70 kg	approx. 70 kg

Coiler head for coil unwinding

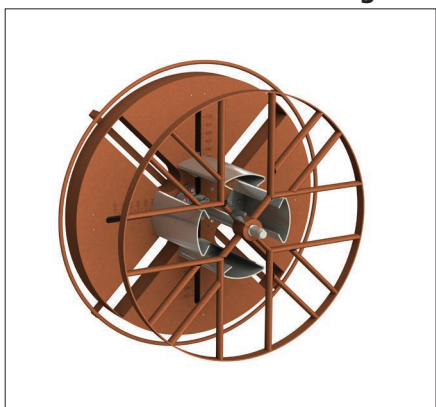

Coiler head continuously adjustable	RAPID 480 SL Part No. 85100082	RAPID 800 SL Part No. 85100101
Coil-Ø	max. 480 mm	max. 800 mm
Core adjusting range	200-370 mm	300-550 mm
Coil width	50- 250 mm	50-250 mm
Loading capacity	max. 65 kg	max. 80 kg
Axle holder-Ø	30 mm	30 mm
Weight	approx. 40 Kg	approx. 70 kg
Colour	RAL 2004, orange	RAL 2004, orange

Winding axles for spool unwinding

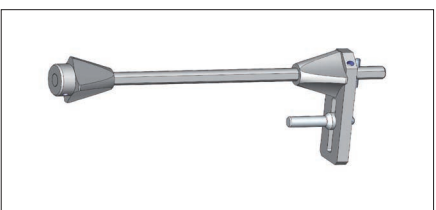

Winding axle for spool 500-600-30	Part-No.	85100103	
Spool-Ø	bis 500 mm	Core adjusting range	40 - 80 mm
Axle length	600 mm	Spool width	250 mm
Axle-Ø	30 mm	Loading capacity	60 kg
Axle holder-Ø	30 mm	Weight	8 kg

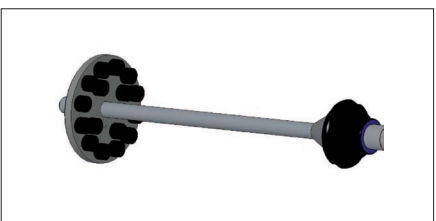

Winding axle for spool-Ø up to 800 mm	Part No.	87000224	
Spool width (Bore 35 mm)	max. 405 mm	Axle holder-Ø	30 mm
Spool width (Bore 50 mm)	max. 415 mm	Core adjusting range	35 - 85 mm
Spool width (Bore 85 mm)	max. 445 mm	Loading capacity	max. 100 kg
Axle-Ø	30 mm	Weight	ca. 10 kg